

PNB 12400 (12V40AH)



ISO 9001
BUREAU VERITAS
Certification



*** The color and the printed specifications of the products are subject to change without prior notice.

Plate	Paste type
Container/cover	ABS(Optional F.R)
Sealant	Epoxy Resin
Separator	Absorptive Glass Mat
Electrolyte	Electrolyte Suspension

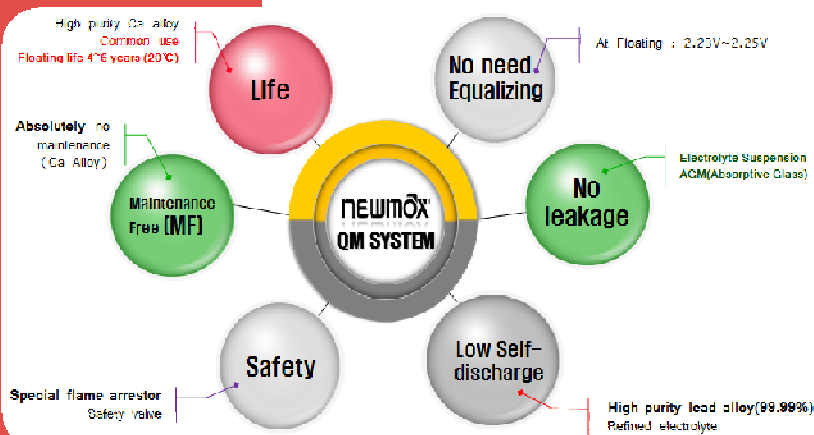
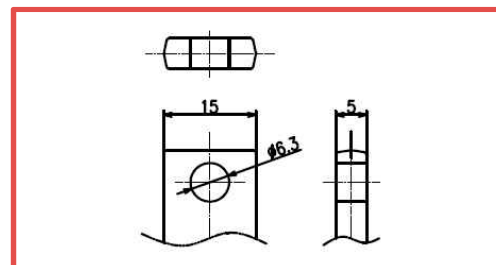
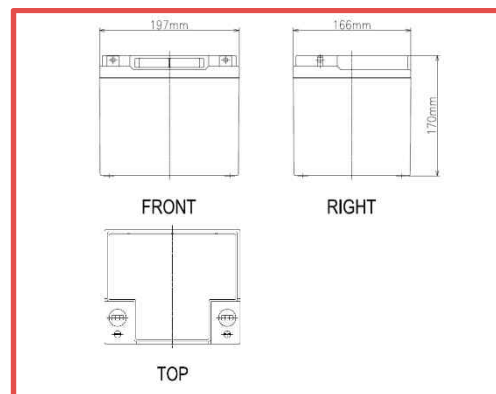

Battery model	PNB 12400 (12V40AH / 10 HOUR RATE)			
Rated Capacity (@25°C)	20HR (1.80VPC)	10HR (1.75VPC)	5HR (1.70VPC)	1HR (1.60VPC)
	42Ah	40Ah	36Ah	27Ah
Dimensions (mm/inch)	Length	Width	Height	Total Height
	197(7.76)	166(6.54)	170(6.69)	170(6.69)
Approx. weight	13.0kg (28.7lbs)			
Internal resistance	Approx. 7.5 mΩ (@25°C, 77°F)			
Max. discharge current (5sec)	160 A	Max. discharge current (continuous)		80A
Capacity affected by Temperature	@30°C (86°F)	@25°C (77°F)	@10°C (50°F)	@-10°C (14°F)
	105%	103%	95%	78%
Self discharge (@25°C, 77°F)	After 1 month 3%		After 3 month 8%	After 6 month 15%
Max. short duration discharge current (0.1sec)	720 A			
Recommended Charging (@25°C)	Cycle use		Floating use	
	2.40~2.50V/cell (±5.5mV/°C/Cell) / 16.0A max.		2.23~2.25V/cell (±3.3mV/°C/cell)	



Effect of temperature on capacity

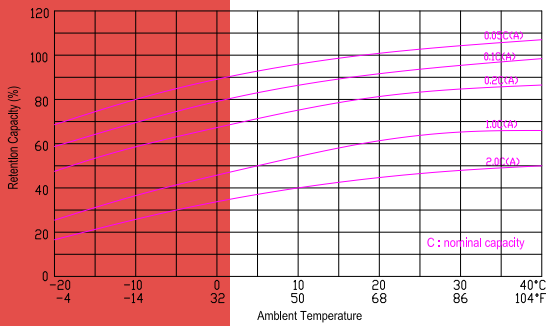

Self discharge

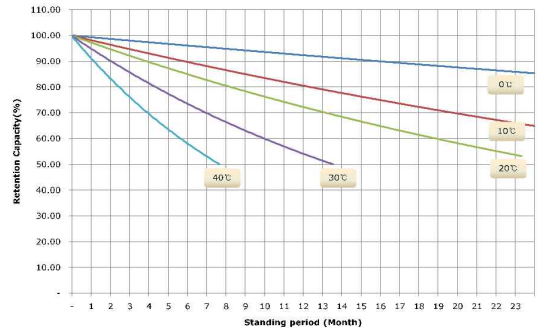

Discharge time vs current

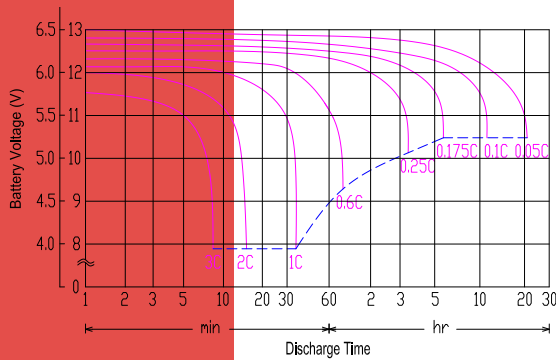

Floating life characteristics

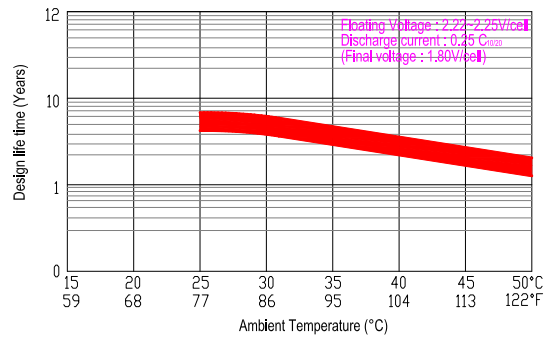

Cycle life vs DOD %

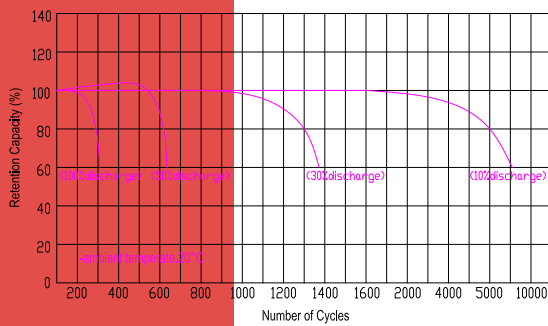

Floating life for capacity characteristics

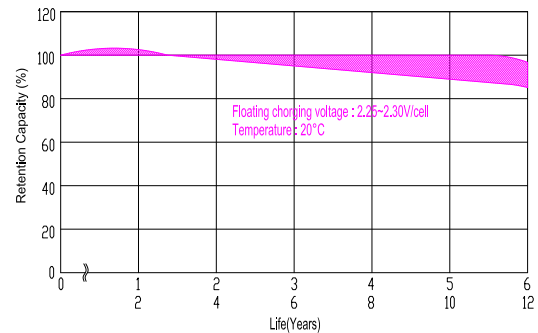

Constant current discharge ratings – Amperes per cell @ 25°C

V/cell	Minutes						Hours					
	5	10	15	20	30	40	1	3	5	8	10	20
1.90V	77.2	64.4	60.4	49.2	40.9	34.8	25.0	10.0	6.3	4.4	3.7	1.94
1.85V	92.0	76.0	69.4	56.4	45.5	38.8	25.6	10.4	6.6	4.6	3.9	2.05
1.80V	107	84.8	74.6	59.8	46.7	40.0	25.8	10.8	6.7	4.7	4.0	2.10
1.75V	116	89.6	77.6	64.6	47.7	41.2	26.0	11.2	6.9	4.8	4.1	2.15
1.70V	125	94.0	80.4	62.8	48.3	41.5	26.1	11.4	7.3	5.0	4.2	2.21
1.65V	129	96.0	81.6	63.9	48.8	41.6	26.2	11.8	7.4	5.2	4.4	2.31
1.60V	132	98.0	82.2	64.4	48.9	41.7	26.4	12.0	7.6	5.3	4.5	2.36

Constant power discharge ratings – Watts per cell @ 25°C

V/cell	Minutes						Hours					
	5	10	15	20	30	40	1	3	5	8	10	20
1.90V	150	125	117	95	81	69	49	19.7	12.5	8.7	7.4	3.9
1.85V	178	147	135	109	90	76	50	20	12.9	9.1	7.8	4.1
1.80V	208	165	145	116	92	79	51	21	13.2	9.4	8.0	4.2
1.75V	224	174	151	119	94	81	51	22	13.6	9.7	8.2	4.3
1.70V	242	182	156	122	95	82	51	22	14.3	10.0	8.5	4.4
1.65V	235	186	158	124	96	82	52	23	14.6	10.4	8.8	4.6
1.60V	257	190	159	125	96	82	52	24	15.1	10.6	9.0	4.7

